

SIMPL Screen

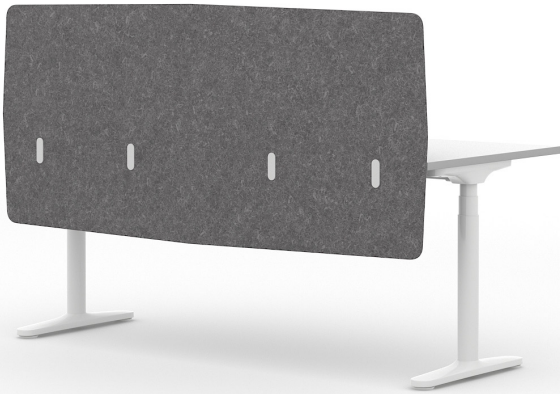

Features:

Simpl is a frameless, lightweight screen solution that can be worktop or frame mounted using a variety of substrates. Simpl Screen is a pinnable screen available in a range of sizes and shapes.

Options:

- Worktop Screw-Fixed: Classic, Sweep, Elevated & Curve
- Worktop Clamp-on: Classic or Sweep
- Frame mounted: Spine

Design: ZENITH DESIGN STUDIO

Warranty: 10 years

Finishes:

12mm Sonic Board:

Zenith select range or other PET on request

Brackets:

Powder coated

Sonic Board with Black Satin Bracket:



Light Grey
ZPET_004



Ash
ZPET_007



Olive
ZPET_010



Shadow
ZPET_011

Sonic Board with White Satin Bracket:



Cloud
ZPET_012

Note: Other bracket powder coat colours available on request



Worktop Screw-fixed

- Compatible with 18mm, 25mm and 33mm worktops
- Refer to Screen compatability Matrix Document
- (screen width = 600 – 900mm to match worktop depth)

Dimensions

STANDARD

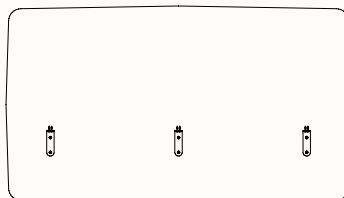
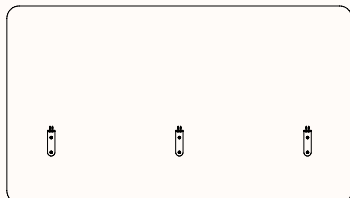

Classic Shape

Width Range: 500-2000mm

Screen Actual Height: 205-800mm (depending on worktop thickness)

Screen Height Above Desk:

Min: 50mm

Max: 480mm

Screen Height Below Desk:

Min: 130mm

Sweep Shape

Width Range: 500-2000mm

Screen Actual Height: 205-800mm (depending on worktop thickness)

Screen Height Above Desk:

Min: 50mm

Max: 480mm

Screen Height Below Desk:

Min: 130mm

ELEVATED

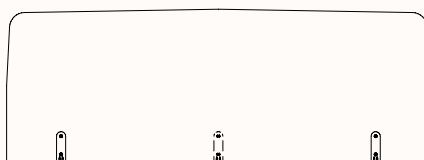
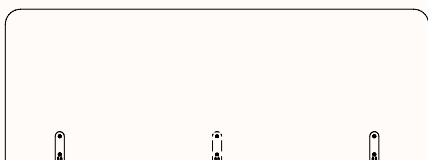

Classic Shape

Width Range: 500-2000mm

Screen Actual Height: max 505mm

Worktop rear corner radius: R50

Screen Height Above Desk:

Min: 150mm

Max: 480mm

Sweep Shape

Width Range: 500-2000mm

Screen Actual Height: max 505mm

Worktop rear corner radius: R50

Screen Height Above Desk:

Min: 150mm

Max: 480mm

Worktop Screw-fixed

- Compatible with 18mm, 25mm & 33mm worktops
- Classic Shape only
- Refer to Screen compatability Matrix Document

Dimensions

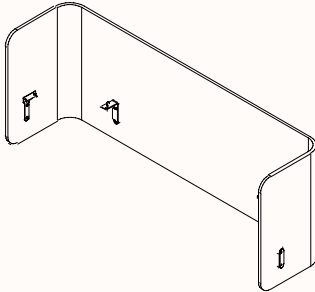

Curve

Worktop Length Range: 800-2400mm

*Return Length: 300-800mm

Screen Actual Height: 198mm min (depends on worktop thickness) – 800mm max

Worktop rear corner radius: R50

Screen Height Above Desk:

Min: 50mm

Max: 480mm

Screen Height Below Desk:

Min: 130mm

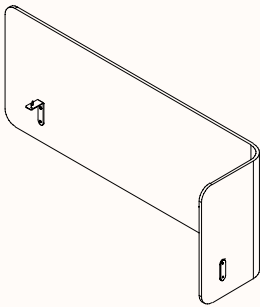

Curve RH

Worktop Length Range: 800-2400mm

*Return Length: 300-800mm

Screen Actual Height: 198mm min (depends on worktop thickness) – 800mm max

Worktop rear corner radius: R50

Screen Height Above Desk:

Min: 50mm

Max: 480mm

Screen Height Below Desk:

Min: 130mm

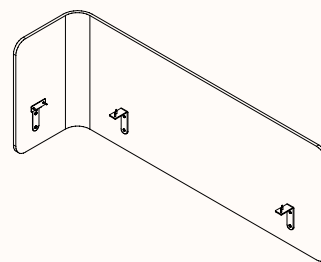

Curve LH

Worktop Length Range: 800-2400mm

*Return Length: 300-800mm

Screen Actual Height: 198mm min (depends on worktop thickness) – 800mm max

Worktop rear corner radius: R50

Screen Height Above Desk:

Min: 50mm

Max: 480mm

Screen Height Below Desk:

Min: 130mm

*Note: Overall screen length limited by substrate

Worktop Clamp-on

- Compatible with 18mm and 25mm worktops
- Refer to Screen compatability Matrix Document

Dimensions

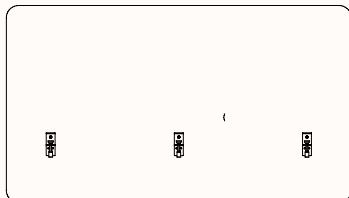

Classic Shape

Width Range: 500-2000mm

Screen Actual Height: 198-800mm (depending on worktop thickness)

Screen Height Above Desk:

Min: 50mm

Max: 480mm

Screen Height Below Desk:

Min: 130mm

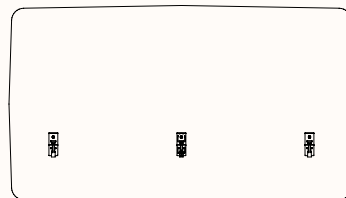

Sweep Shape

Width Range: 500-2000mm

Screen Actual Height: 198-800mm (depending on worktop thickness)

Screen Height Above Desk:

Min: 50mm

Max: 480mm

Screen Height Below Desk:

Min: 130mm

Frame Mounted Spine

- Compatible with Classic Shape only
- Screen gap is fixed at 30mm
- Screen width must equal length of workstation
- Post is round for workstations with round legs
- Post is square for workstations with rectangular legs

Dimensions

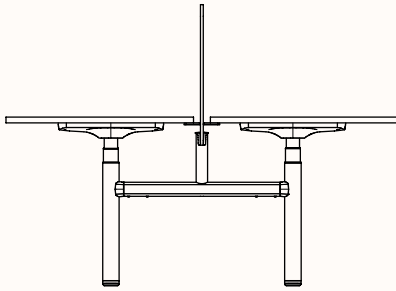

Spine

Width Range: 1200 -2000mm

Screen Overall Height: 900-1250

Screen above floor Height:

Fixed: 600mm