

Method Installation Instructions

This is a practical guide to help you install your Method bins, you can find video guides and further recycling resources at methodrecycling.com/resources.

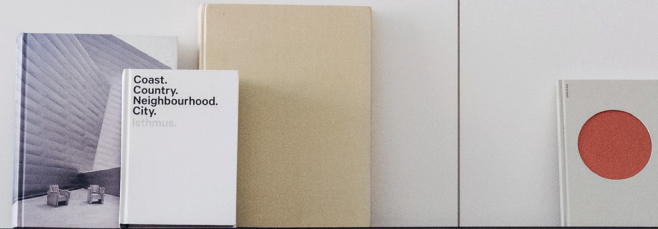

Contents:

1. How to put a Method bin together
2. Placing a bin liner with the bag reatiner
3. Installing your HD Connector
4. Attaching HD Expansion Kit
5. Precycler assembly and care
6. Cleaning your Method bins and accessories
7. How to apply vinyl labels

Please consider the environment before printing

Method Installation Instructions - How to put a bin together.

You have received your bins, what next?

Bin Parts:



1. Remove your bin bases, lids and bag retainers from their boxes. If you don't want to keep the cardboard packaging it is completely recyclable.

2. Gently pull the lid off the bag retainer. Place the bag retainer, pictured on the left, into the base of the bin. The ridges on the side should fit neatly into the slits on the side of the bin.

3. Put in your chosen bin liner, making use of the Bag Retainer to maintain the sleek lines and avoid the liner looking like an untucked shirt, detailed instructions on the next page.

4. Gently place on the lid, open or closed.

Voilà you have put together your first Method bin.

Read our Bin Placement Guide to optimise the use of your bins - www.methodrecycling.com/resources/bin-placement-guide.

Specifications

CAD files available: methodrecycling.com/resources

60L capacity (per bin)

Made from polypropylene

NZ Pat: 620337

NZ Reg Design: 418203

AUS Reg Design: 11087/2014

US Reg Design: D731,729 SSo you

Continue reading to find instructions on how to; install bin liners, assemble precyclers, attach HD connectors, clean the bins, apply vinyl labels and some advice on selecting a waste provider.

Method Installation Instructions - How to place a bin liner.

We have designed our patented Bag Retainer System to maintain the sleek lines of your recycling bins and stop the bag from hanging out like an untucked shirt. Print this page for step by step instructions on how to place a liner correctly.



Step 1.

Place the liner in the bin, pushing it to the bottom. Wrap the liner over the top of the bin.



Step 2.

Collect the excess liner at the front and twist it.



Step 3.

Tuck the twisted liner into the groove in the front of the bin, this should hold the liner in place and you are ready to place the lid on.



The end result should be a clean bin, with no visible liner.

Continue reading to find instructions on how to; assemble precyclers, attach HD connectors, clean the bins, apply vinyl labels and some advice on selecting a waste provider.

Method Installation Instructions - Assembling the HD Connector.

The HD Connectors allow you to lock your Method bins in place, side-by-side, back-to-back or fix them to a wall. All you need is a standard hex key. On this page we will walk you through the steps to assemble the HD connector before you attach them to the bins. You can also find a video guide at www.methodrecycling.com/assembly.

PARTS

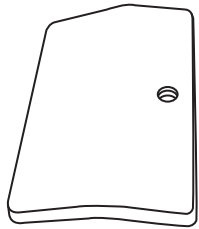

Locking Plate



Screw



Bar

EQUIPMENT

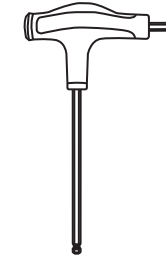

Hex Key

Screw each Locking Plate to the bar using a Hex Key.

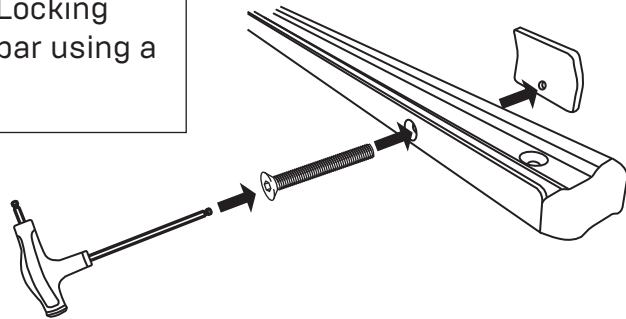

Please Note: Do not tighten the screw, leave it loose. There must be a gap (0.5cm) between each Locking Plate and the Bar.

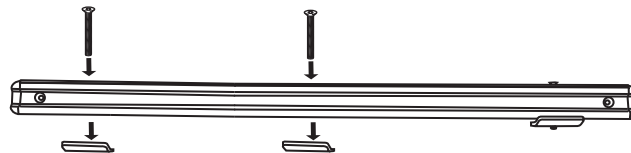
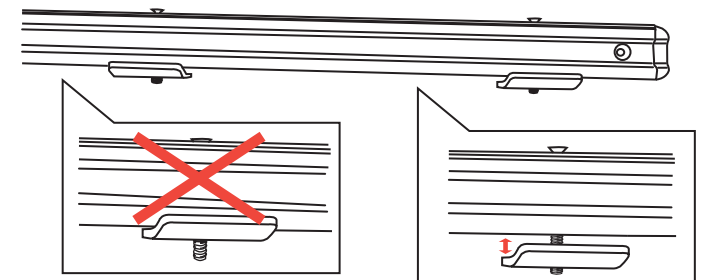

Continue to the Next pages to see how to attach the bins side-by-side and to a wall with the HD Connector.

Method Installation Instructions - Connecting bins together with a HD Connector.

On this page we will walk you through the steps to lock the Method bins side-by-side with the HD Connector. You can also find a video guide at www.methodrecycling.com/assembly.

Secure the HD Joiner to your Method Recycling Station

- I. Clamp the Locking Plate and Bar to each Method Bin Base.
- II. Note: the Locking Plate must clamp on the back of the Bin Base handle, and the lip on the Bar must clamp on the lip of the top of the Bin Base.
- III. Tighten the Screw using the Hex key for each Locking Plate.
- IV. Test: The HD Joiner has been correctly installed when you can pick up the Method Recycling Station using the HD Joiner and the bins are securely in place.

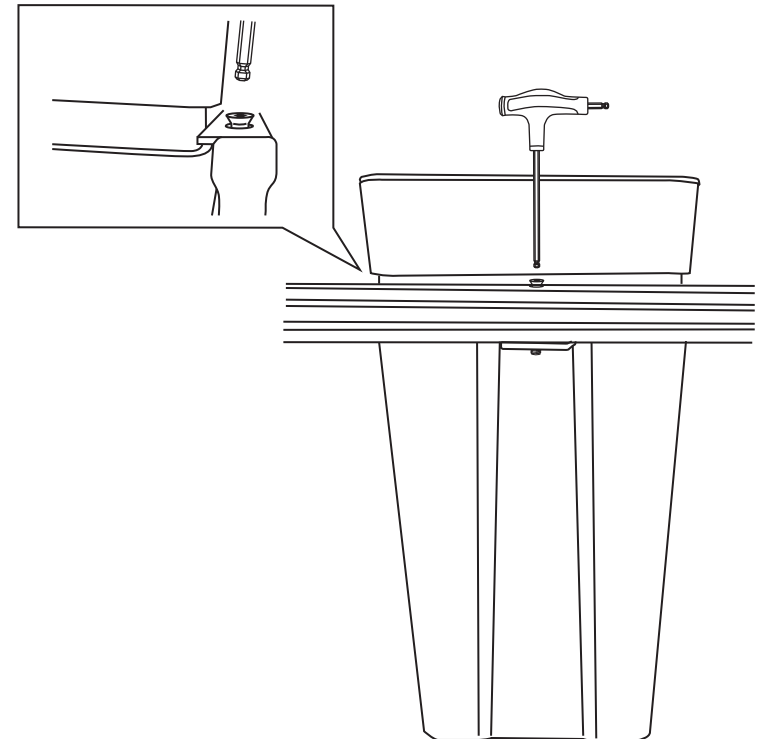
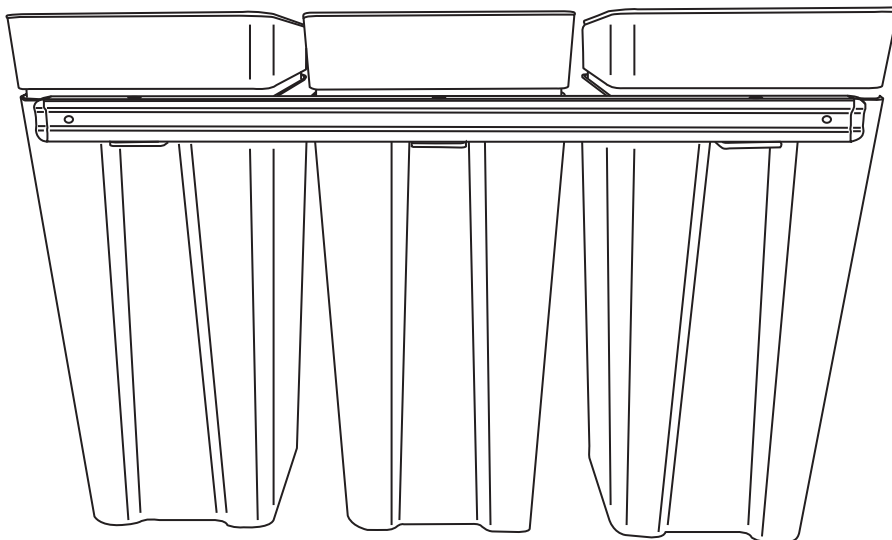

Continue reading to find instructions on how to use the HD Connector to attach the bins to a wall.

Method Installation Instructions - Fixing the bins to a wall with a HD Connector.

On this page we will walk you through the steps to lock the Method bins to a wall with the HD Connector.

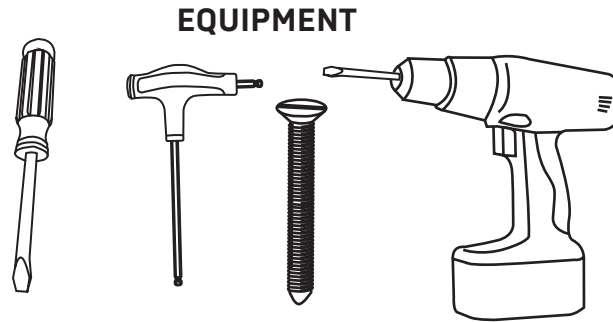

1. Remove hole covers on HD Connector.

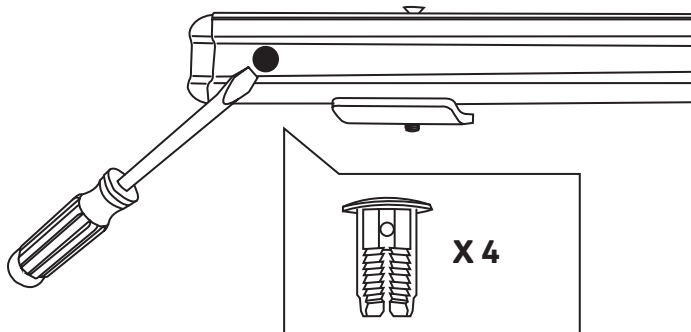

2. Position assembled station against wall/ surface you wish to mount to.

- I. Ensure surface is suitable to have the station mounted on.
- II. Remove 1 method bin from the set leaving the HD Connector and rest of the set in place against your surface.

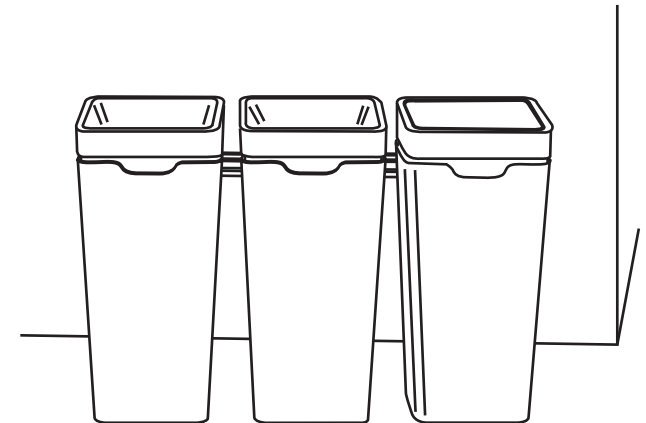

Continued on the next page.

Method Installation Instructions - Fixing the bins to a wall with a HD Connector continued

3. Using a drill, drill and screw HD Connector to the wall.

I. Use appropriate screw/wall fastening.

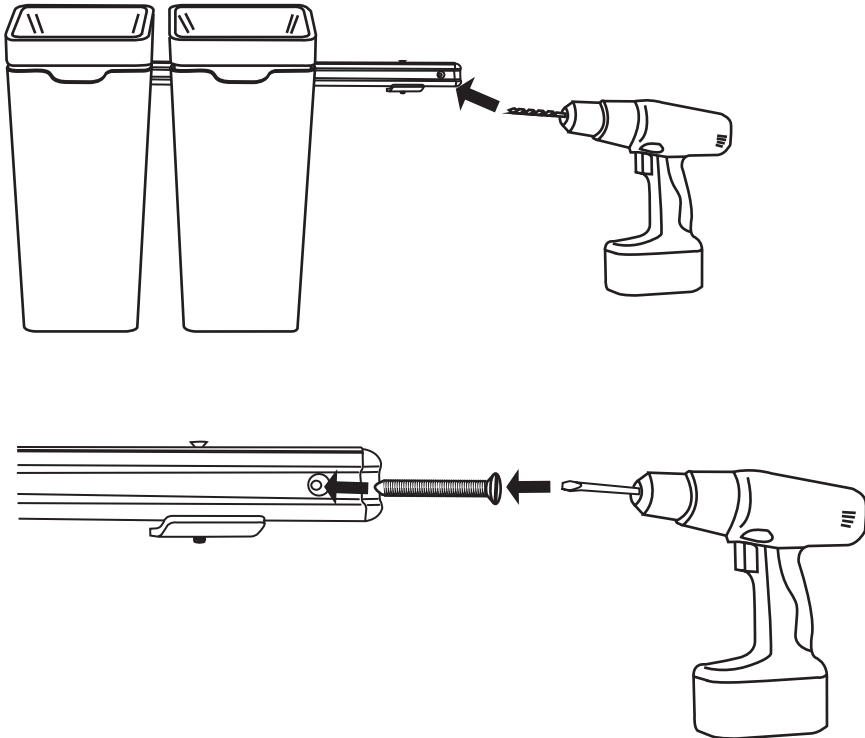

4. Reattach removed Method recycling bin.

I. Leaving the lid off the Method base bin will allow better access to the screw and locking plate when reassembling.

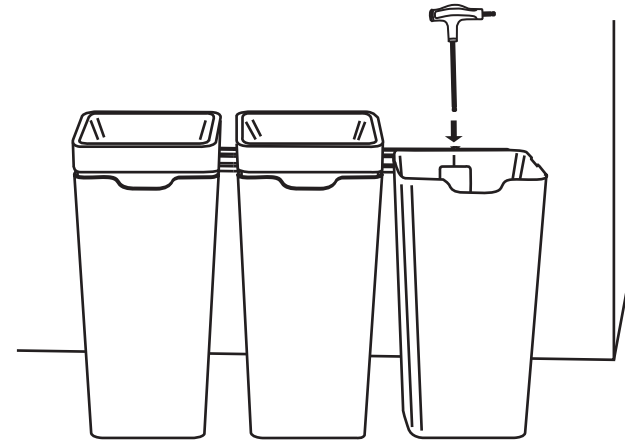

5. Repeat steps 2-4 for opposite end of Station.

Continue reading to find instructions on how to; attach an HD Expansion Kit, assemble precyclers, clean the bins and parts, apply vinyl labels and some advice on selecting a waste provider.

Method Installation Instructions - Attaching an HD Connector Expansion Kit.

For recycling stations of 4 or more bins you will need to extend your HD Connector with an HD Expansion Kit.

Expansion Kit - no tools needed.



1. Pull out the plastic covers from the end of two HD Connectors



2. Firmly insert the prongs of the expansion piece into the slots inside the HD Connectors on both sides.

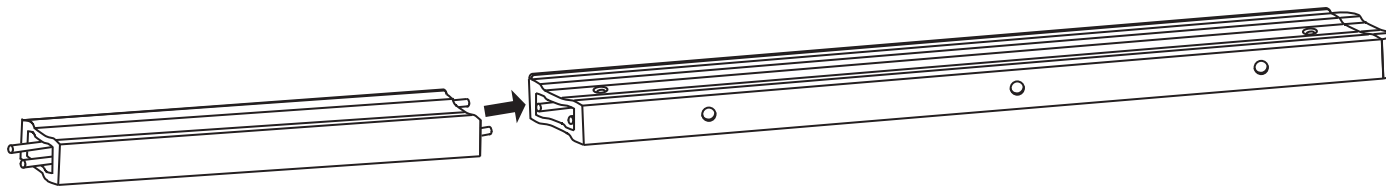

Continue reading to find instructions on how to; assemble precyclers, clean the bins and parts, apply vinyl labels and some advice on selecting a waste provider.

Method Installation Instructions - Assembling your precyclers.

No tools needed, snap your precyclers together quickly. They easily un-snap for cleaning, and are dishwasher safe.

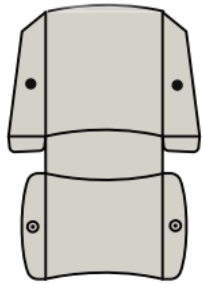

Paper Precyclers

1. Place precycler on a flat surface (Method logo facing down).

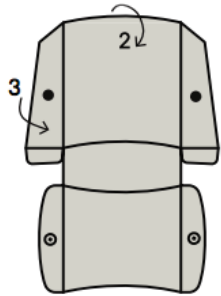

2. Fold longer side upwards at base.
3. Fold one side flap inwards.

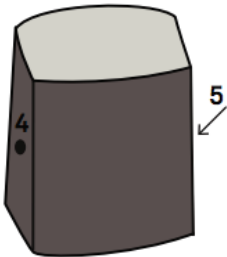

4. Clip Buttons on that side together.
5. Repeat steps 3 - 4 for other side.

Voilà, your precyclers are ready to separate waste at your desk.

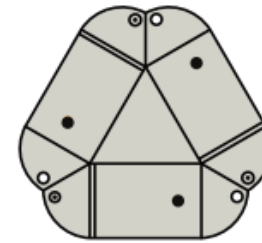

Waste Precyclers

1. Place precycler on a flat surface (Method logo facing down).

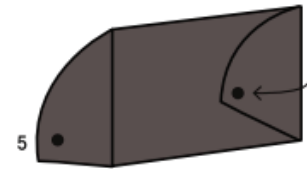

2. Pull up one side and bend verticle corner folds.
3. Push the button through the hole and fold edges together inwards.

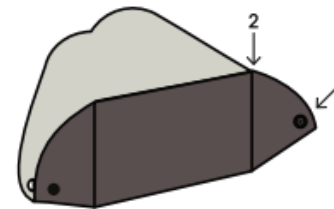

4. Push edges together towards front edge and clip button.
5. Repeat steps 2 - 4 for remaining two corners.



Continue reading to find instructions on how to; clean the bins and parts, apply vinyl labels and some advice on selecting a waste provider.

Method Installation Instructions - Cleaning and Bin Care.

How to keep your Method Bins and accessories in tip-top shape.

How to Clean Your Method Bins and Lids

To best clean your bins, we advise a soft cloth and a non-abrasive detergent.

We do not recommend putting your method bins through a dishwasher or rinsing touch lids as this may result in damage to the product. Our open lids have been designed with curves to avoid hard to reach places.

How to Clean Your Precyclers

The precyclers can be washed by hand with a soft cloth and a mild detergent, or they can be safely washed in your dishwasher.

Designed for Indoor Use

Method's recycling bins are designed for an indoor environment, therefore we advise against keeping them outside.



Continue reading to find instructions on how to; clean the bins and parts, apply vinyl labels and some advice on selecting a waste provider.

Method Installation Instructions - How to Apply Vinyl Labels.

If you have ordered vinyl labels for your bins there are a few ways to apply them, this is the method we suggest.

1. Use a cloth to dampen the area that the vinyl is going to sit on with a cloth and a solution of warm water and dishwashing liquid. This will allow you to move the vinyl if you do not get the positioning correct on the first go.

2. Lightly place the vinyl on the bin and line it up until it is located where you would like it to be, and is straight.

3. Find a square piece of hard plastic, a ruler or any other firm item that doesn't have sharp edges (to avoid ripping the vinyl). Use it to press the vinyls onto the bin and squeeze out any air pockets.

4. Use a soft, dry cloth to remove any excess liquid from the bin and vinyl.



Continue reading for some advice on selecting a waste provider.



@methodrecycling

Find more recycling resources at: methodrecycling.com/resources



Method Installation Instructions - Choosing a Waste Provider.

With Method bins you have the opportunity to recycle as much waste as possible, selecting a waste provider is an important decision to make sure your efforts are being utilized.

In order to have an exceptional experience with your waste service providers, we advise you to look for and utilise the following:

Dependability

Ascribe your business to those who will collect on time, deliver great customer service, and report back to you.

Understand your waste

Make sure everything that can be recycled is recycled and that you have the right level of collections for your different bins.

Transparency

Know where your waste is going once it leaves your site by researching online or talking to waste service providers.

Read recycling collection contracts

Ensure you delve into contracts and understand the environmental requirements for your workplace before you make a decision.

Check your sites

If you have multiple sites or locations within your facility you will need to complete this process for each of them.

Find your flow

Consult with staff, cleaners, facility managers, and contractors to create a collection schedule that works for everyone.

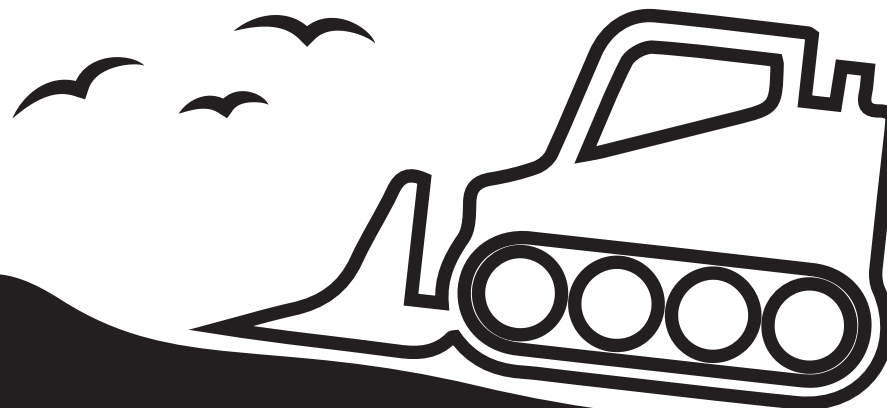

Find more recycling resources at: methodrecycling.com/resources



Method Signage Assembly Instructions



Parts included:

- 1x sign
- 2x bolts
- 2x washers
- 2x nuts

Hardware needed:

- Flathead screwdriver
- Allen key

*To be installed in conjunction with a Method Connector

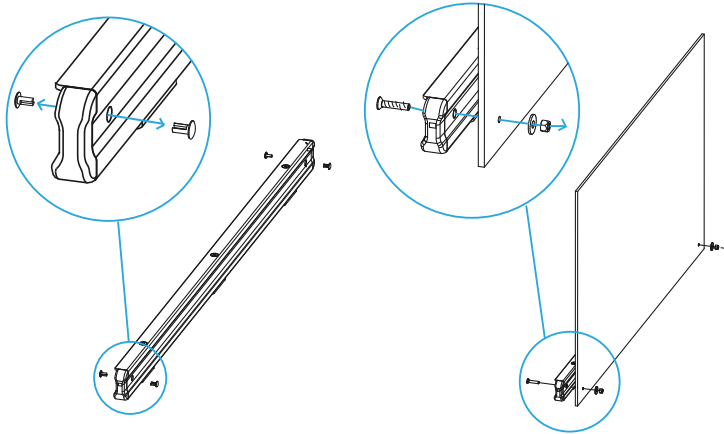

Step 1

Use a flat head screwdriver to remove the plastic rivets from the holes at each end of the Connector.

Step 2

Use an Allen key to bolt the sign to the Connector, placing a washer between the sign and nut to prevent damage.

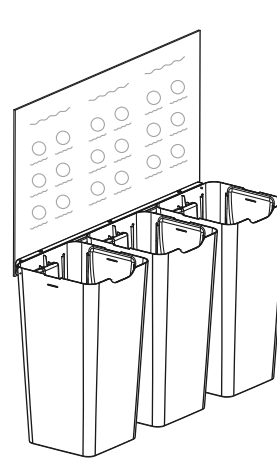

Step 3

Attach the Connector and Signage to the bins. This is easiest with the retainers and lids removed.

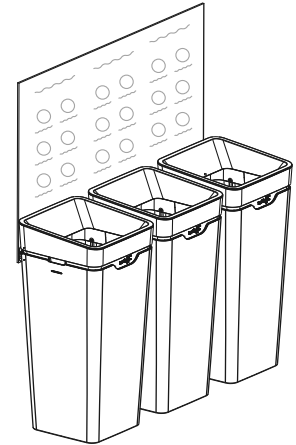

Step 4

Place the retainers and lids back on and you're ready to go.